

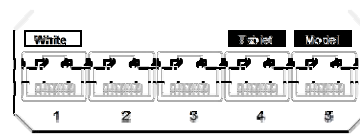

LAN Port

Router set (with AC adapter)



①

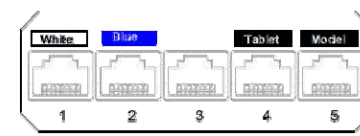

②

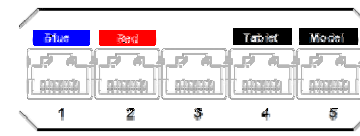

③

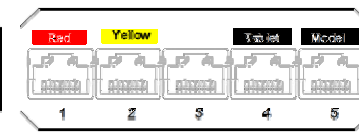

④

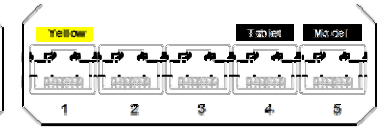

⑤

The number of units that can be controlled simultaneously is 5 units. A seal is affixed to the LAN port on the back of each router as shown in the above figure.

Setting



1.Plug the AC adapter of the router into power plug built-in the Pediatric Lung.



2.Take out the cord from the hole on the lateral side of the Pediatric Lung unit, then connect the AC adapter to the router.

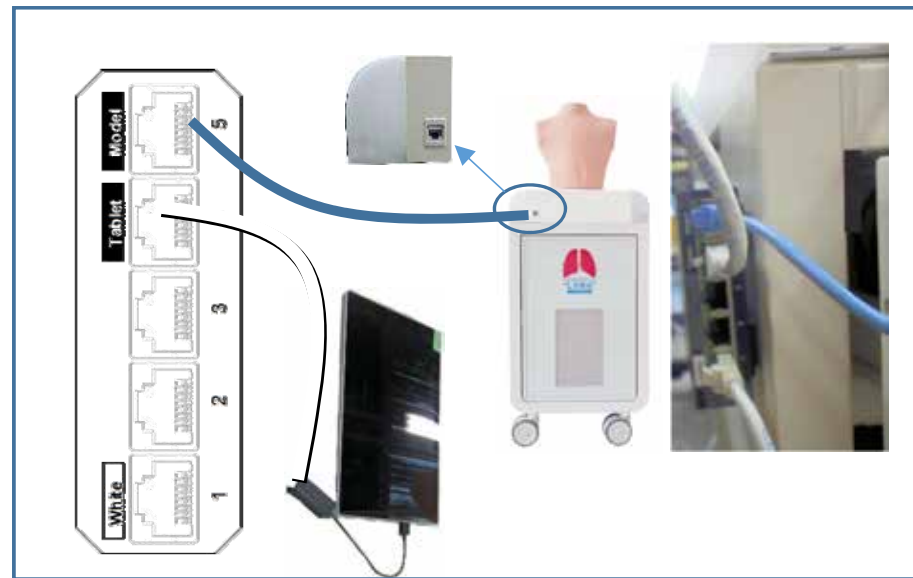

3.Connect the router port marked [Model] to the LAN port of the Pediatric Lung unit.

4.Connect the router port marked [Tablet] to the Tablet PC.

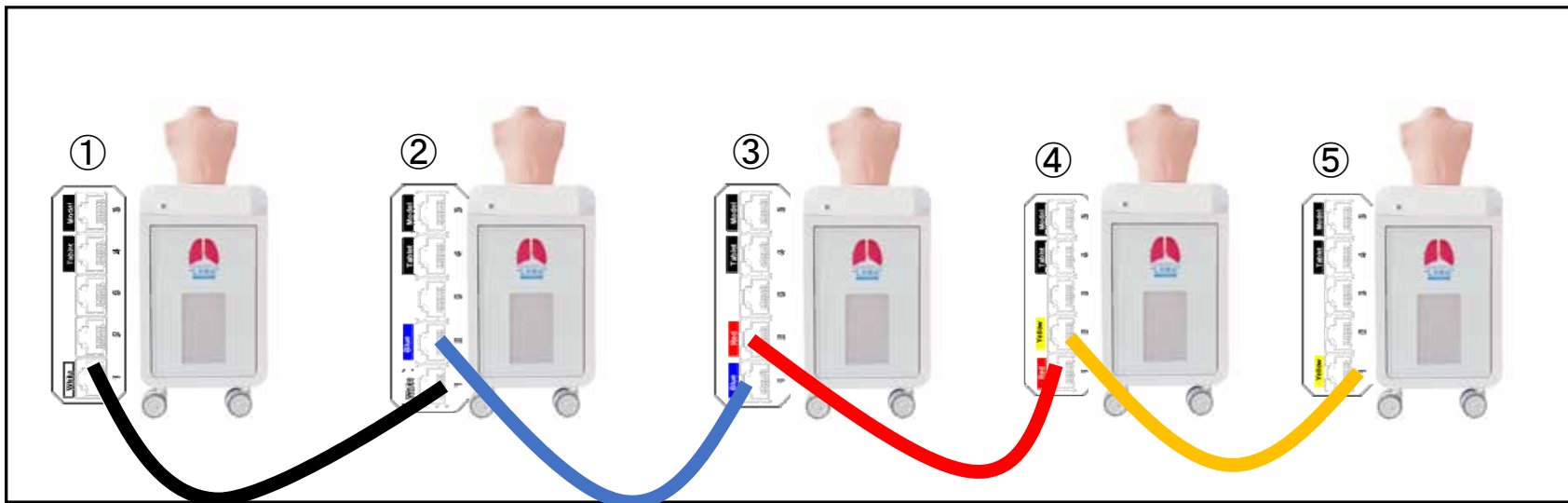

5. Connect the same colored port of each model with the LAN cable.

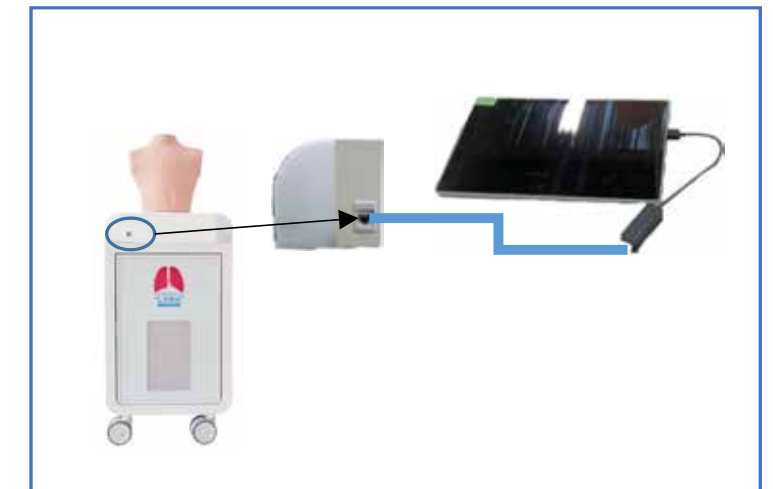

In case of a single unit, connect the LAN port of Pediatric Lung unit to the tablet.